

MARKUS

MSZ 80

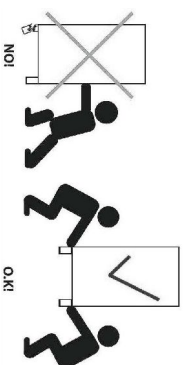
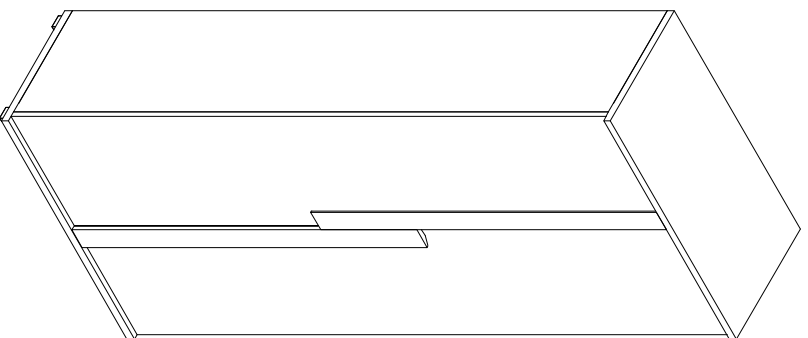

08.06.2016

- (D)** Montageanleitung
- (FR)** Notice de montage
- (NL)** Handleiding voor de montage
- (CZ)** Montážní návod
- (HU)** Szerelési útmutató
- (TR)** Montaj talimatı
- (GB)** Assembly Instructions
- (IT)** Istruzioni di montaggio
- (PL)** Instrukcja montażu
- (SK)** Návod na montáž
- (RO)** Instrucțiunile de montaj
- (RU)** Инструкции по монтажу

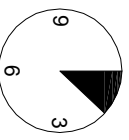
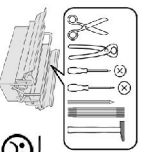

1-1,5

1

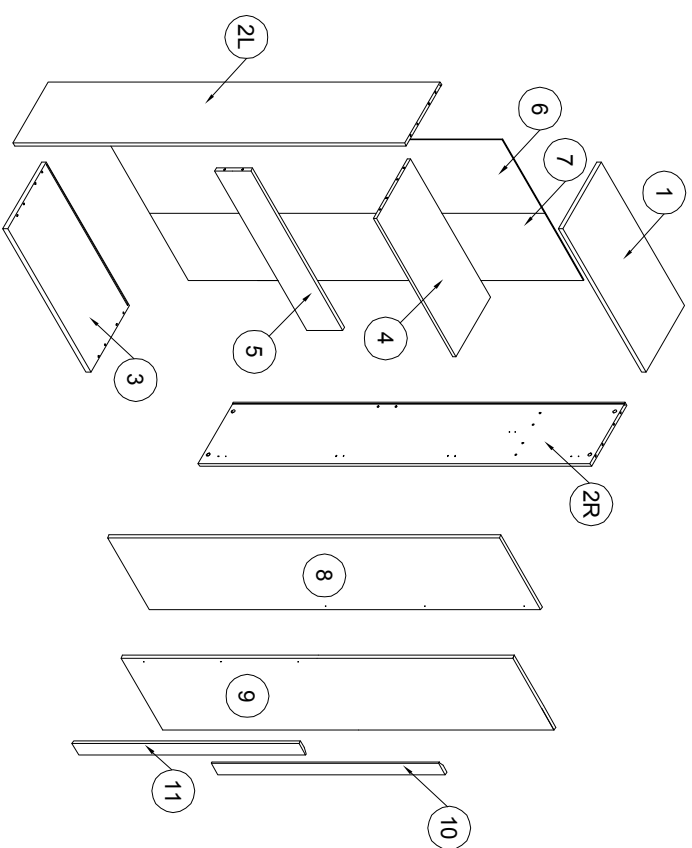

R X8 	H 6.3x13 X16 	A 8x32 X16 	B X12 4x13 	S L-191(8mm) X1 	ND 3.5x16 X10 	N 3x20 X6 	Y X4
X X10 	W6 L-75(8mm) X1 	NF 4x30 X6 	NA 4x13 X16 	P X8 	T X2 	C X12 	Z X12

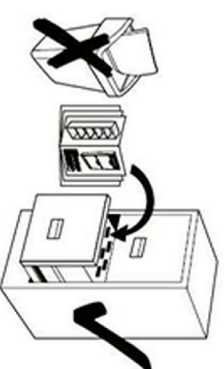
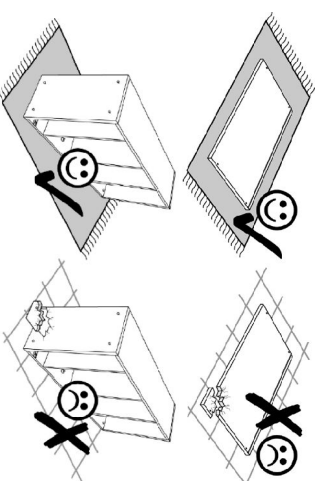

2

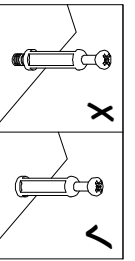

3

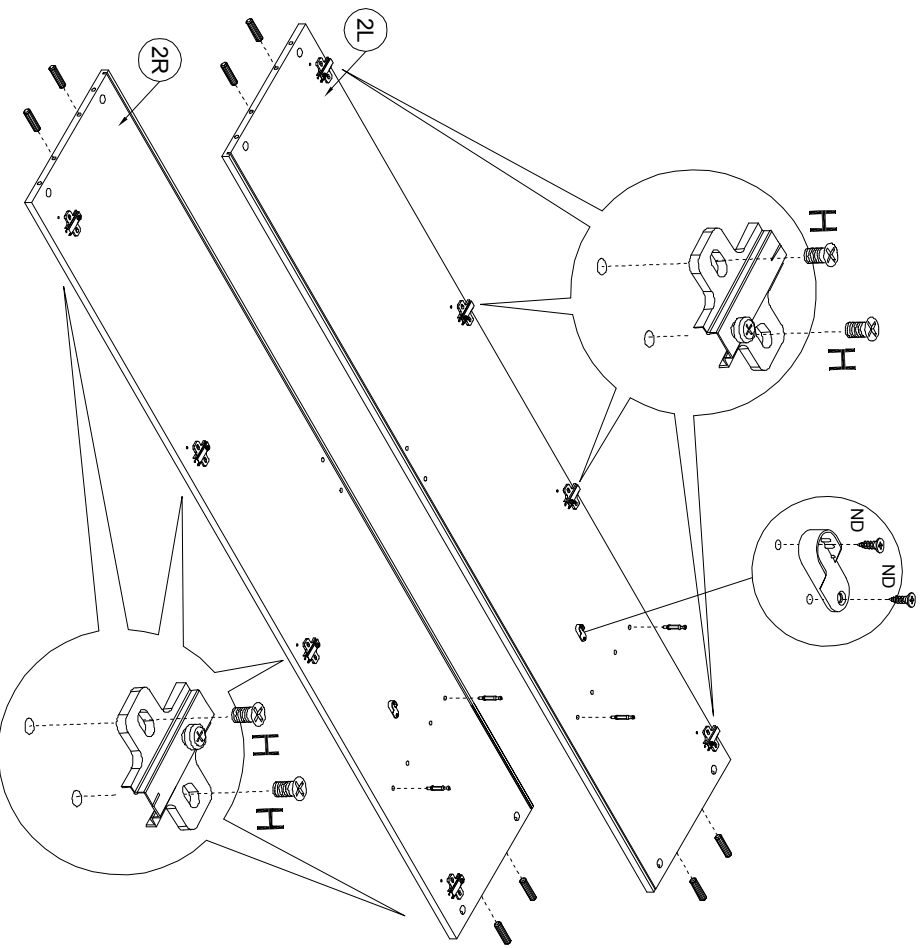

- ND 3.5x16 x4
- T x2
- A 8x32 x8
- B x4
- R x8
- H 6.3x13 x16

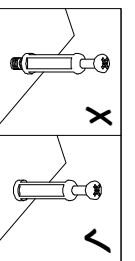

4

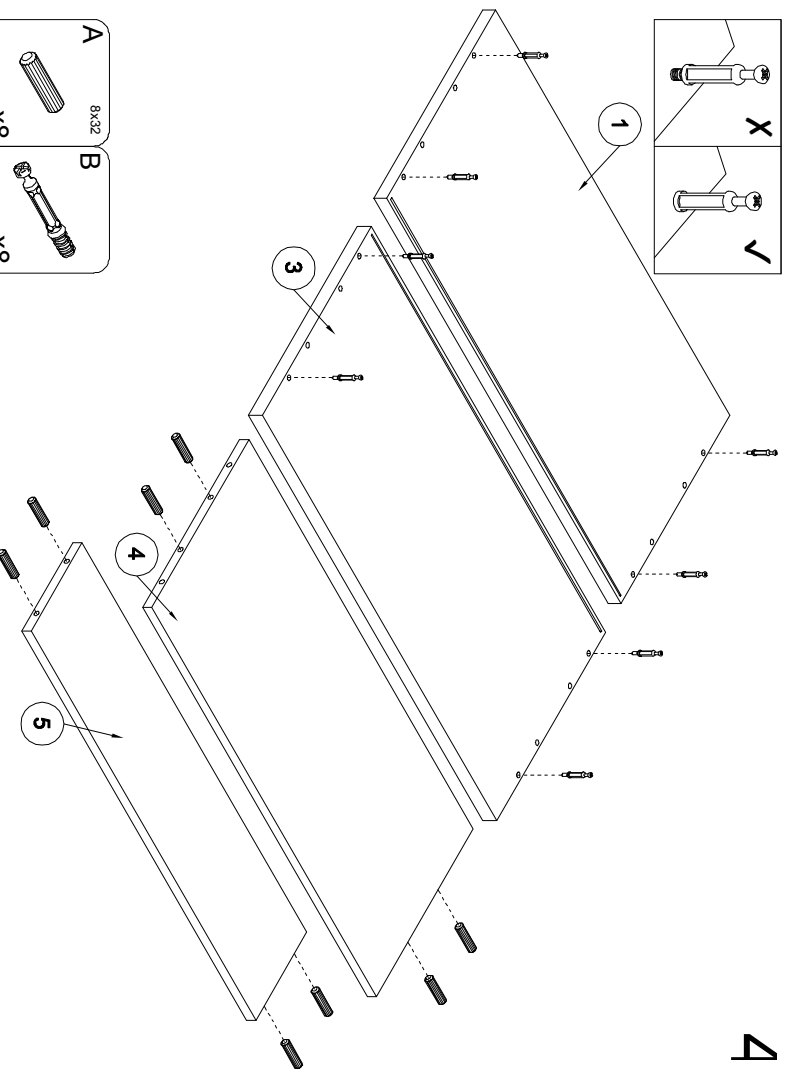

- A 8x32 x8
- B x8

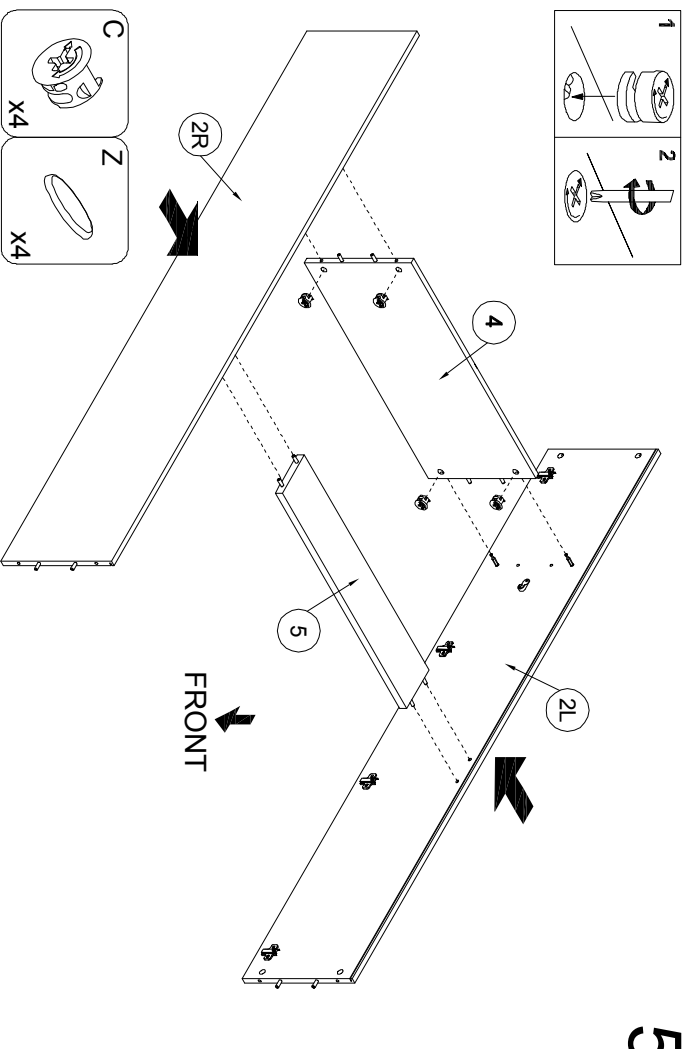
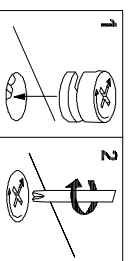

- C x4
- Z x4

5

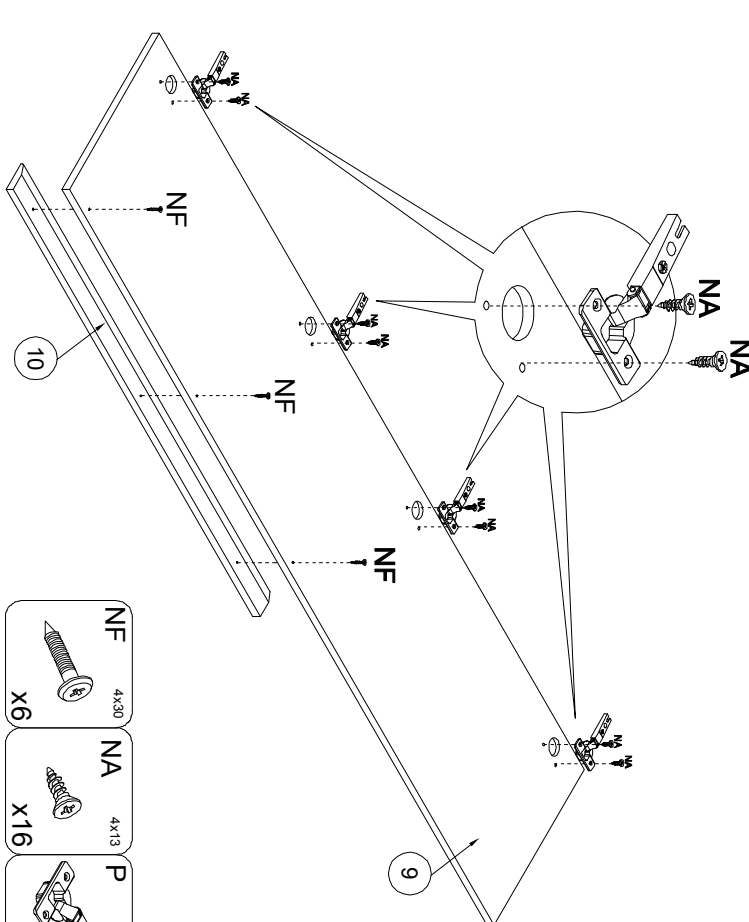
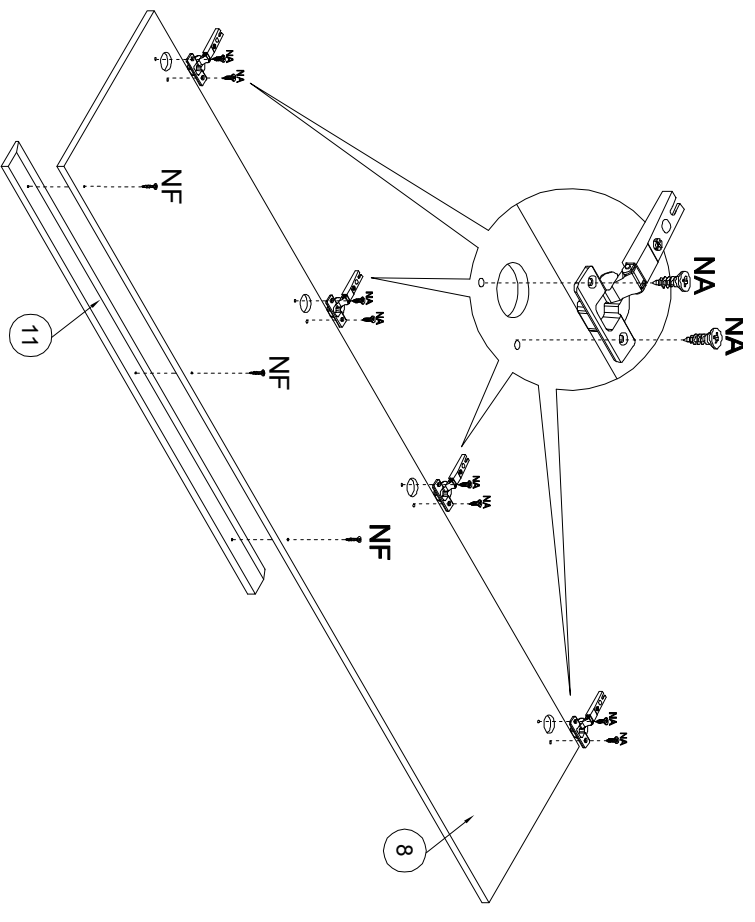
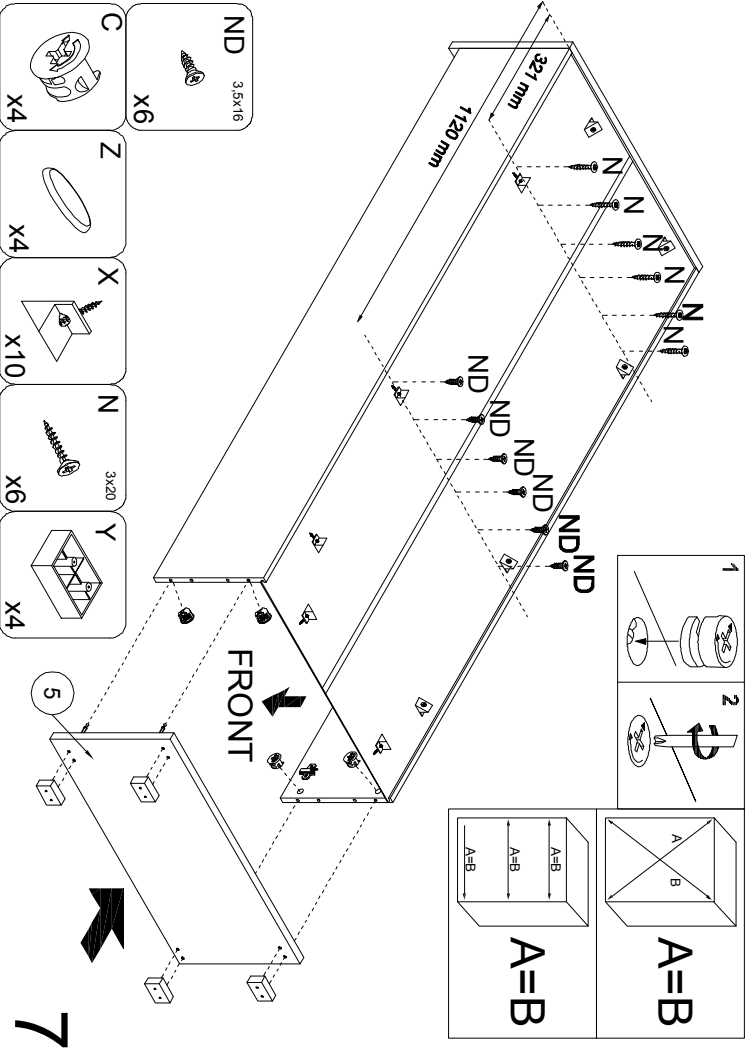
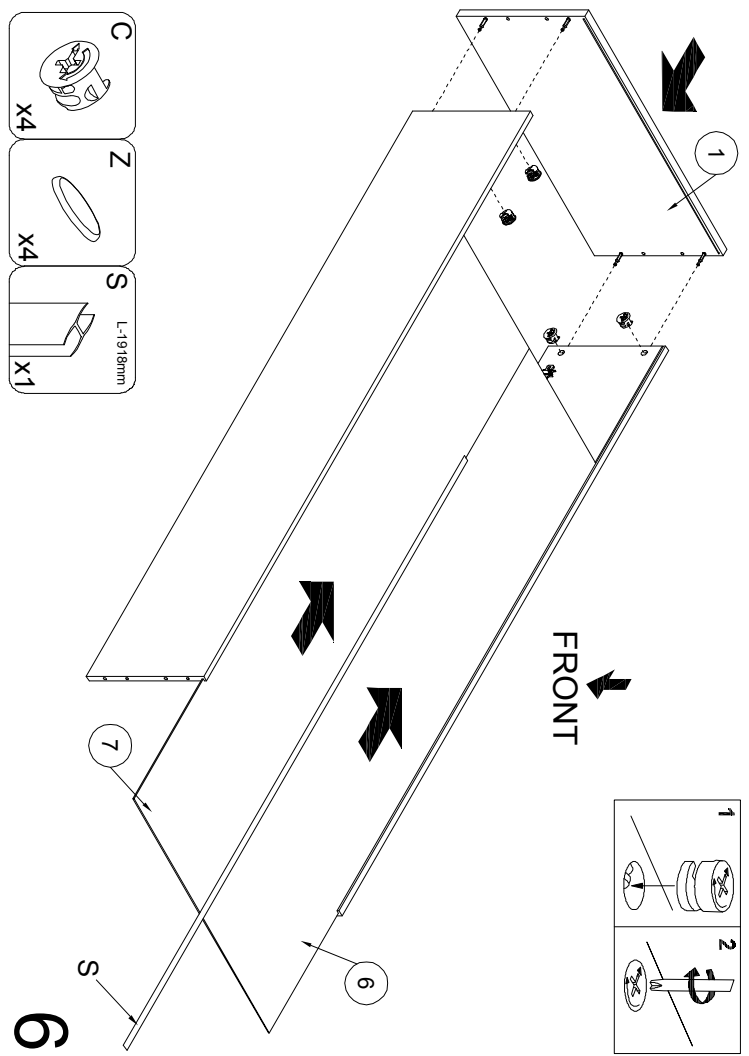

- NF 4x30 X6
- NA 4x13 X16
- P X8

W6 L-758mm
X1

